



36x60 Office Complex

For those big jobs that require the entire team.



SPECIFICATIONS

- » 36' x 60' building size
- » 36' x 64' with towing hitch
- » (6) 12' x 12' private offices
- » (1) 36' x 36' common area
- » 2 entrances
- » 8' ceiling height
- » ADA restrooms optional

FEATURES

- » Central HVAC
- » Fluorescent lighting
- » Electrical outlets
- » 1/8" vinyl floor

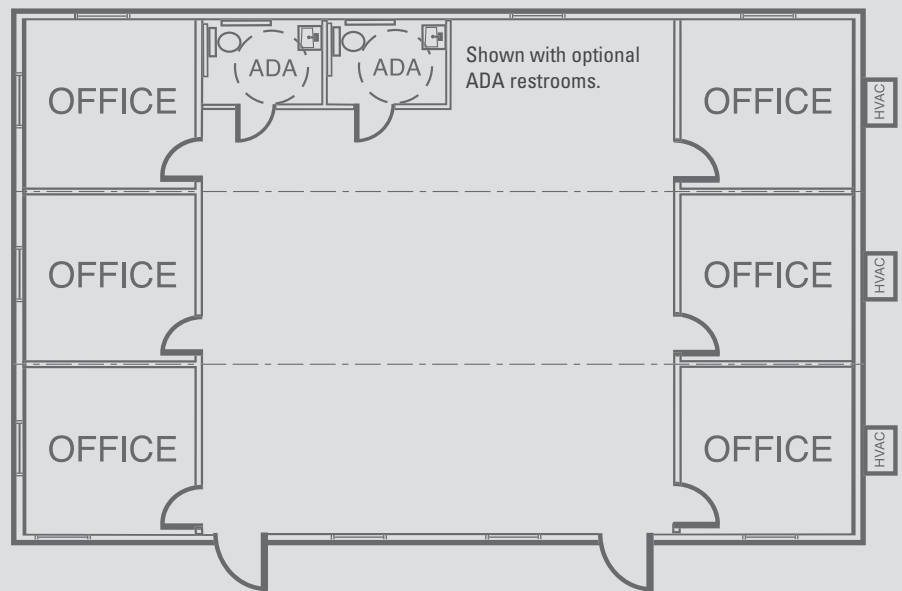

Floor plans may vary. Other sizes, floor plans, configurations and specifications are available.

Ask us about...



STORAGE CONTAINERS

Secure portable storage units in 8' x 20' and 8' x 40' sizes.



FURNITURE

Various prices and styles to fit any budget.



INSURANCE

Optional commercial general liability and damage waiver option.



PORTABLE SANITATION

Hand wash stations, holding tanks, and Porta-Johns.



ACCESSIBILITY

Steps, decks and ramps.

Experienced ★ Local ★ Proven

World-class service you can count on, with guaranteed on-time delivery, and competitive pricing from 80-plus locations across North America.

Call today or visit us online: **800-523-7918** www.ModSpace.com